

Scott County Maps published in 1913

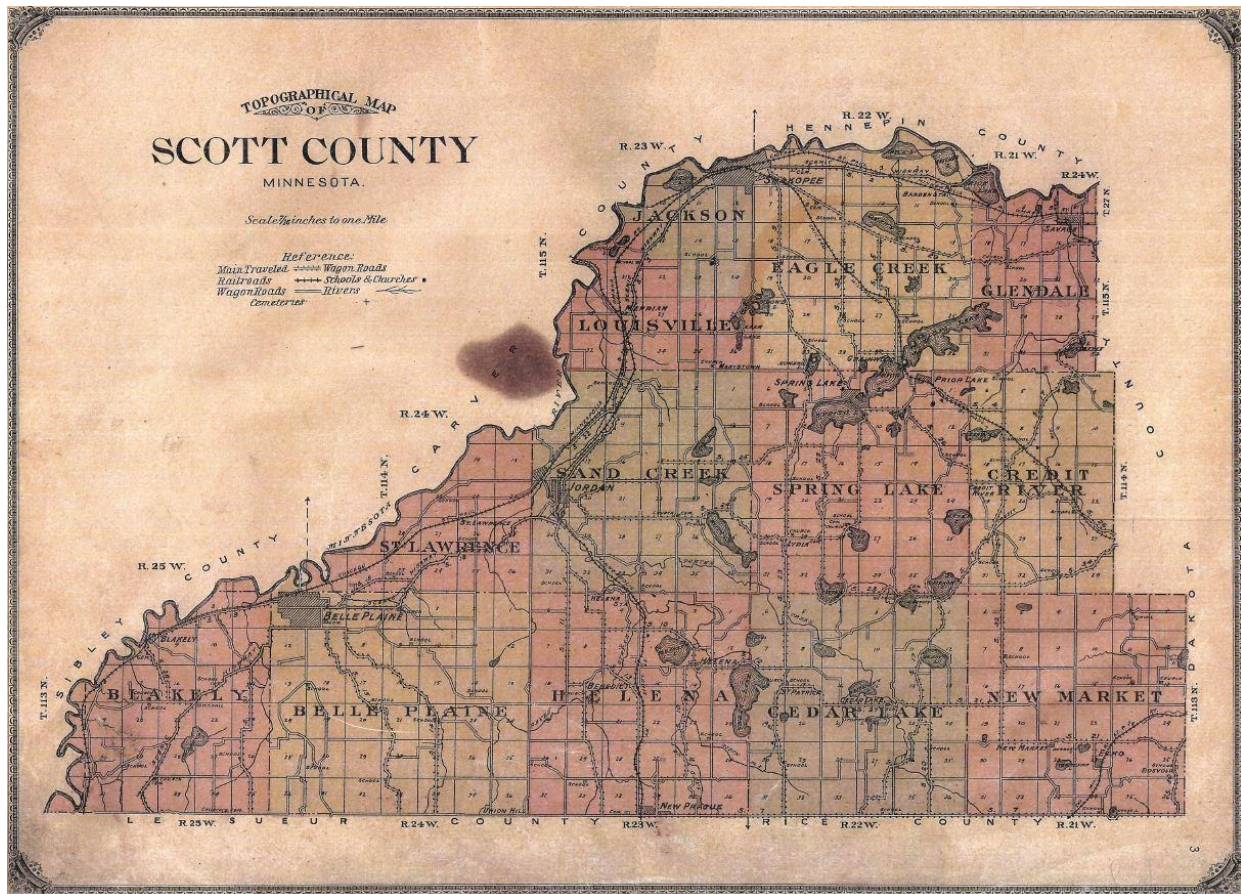

Scale Inches to one Mile

MAP OF CEDAR LAKE

Township 113 North Range 22 West of the 5th P.M.

SCOTT COUNTY MINNESOTA.

- REFERENCES:
- Rail Road — School
 - Wagon Road — Church
 - Corp Line — Houses
 - Creek — Cem.
 - School Districts

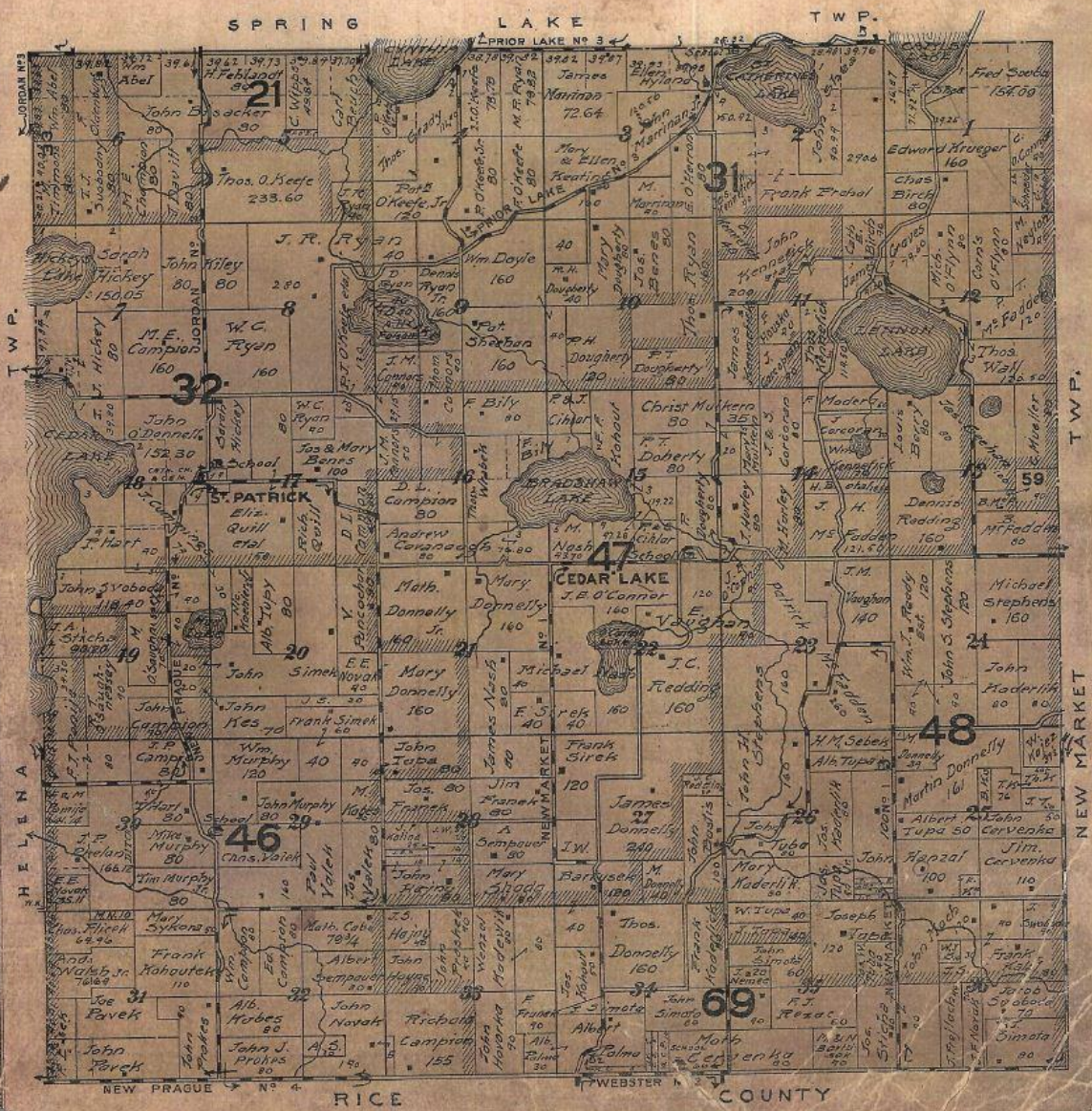

Scale 4 inches to one mile

MAP OF CREDIT RIVER

Township 114 North

Range 21 West of the 5th P.M.

SCOTT COUNTY
MINNESOTA.

REFERENCES:
Rail Road — School —
Wagon Road — Church —
Corp. Line — Houses —
Creek — Cem. —
School Districts —

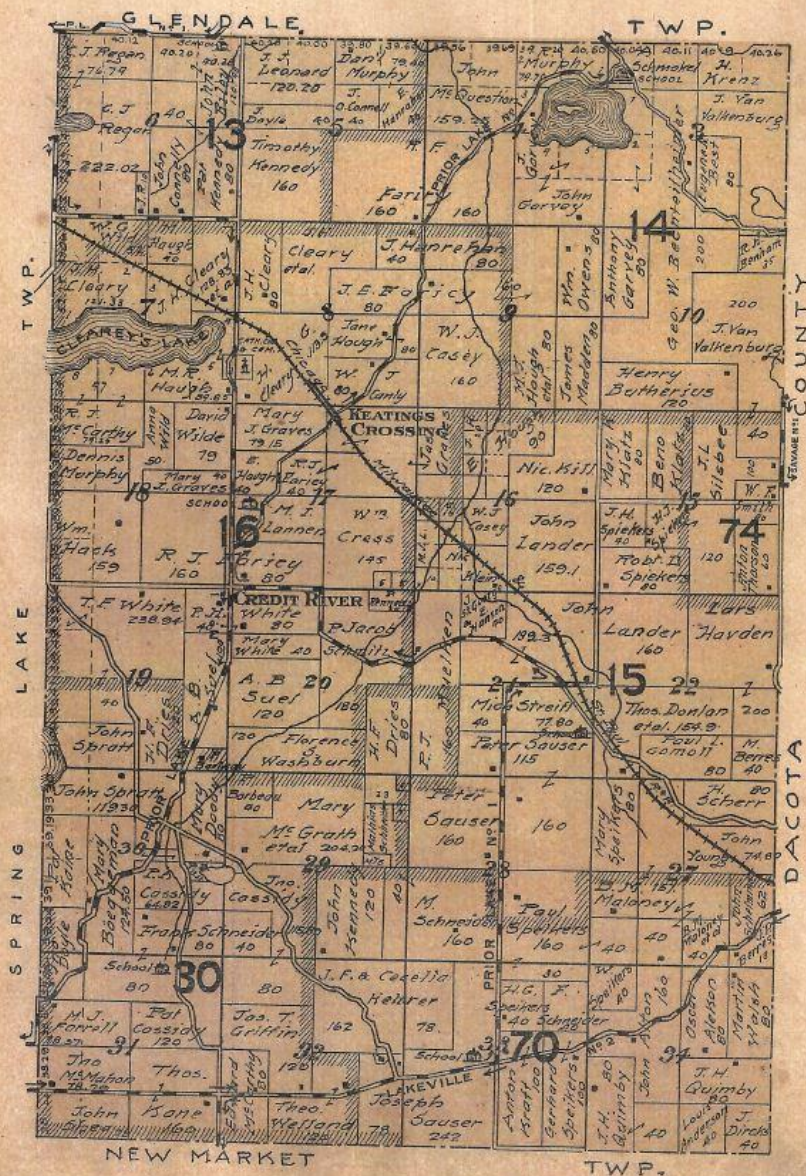

Scale 1/4 inch to one mile.

MAP OF SPRING LAKE

Township 114 North

Range 22 West of the 5th P.M.

SCOTT COUNTY
MINNESOTA.

REFERENCES:
 Rail Road — School —
 Wagon Road — Church —
 Conline — Houses —
 Creek — Cem. —
 School Districts —

